

## INSTALLATION INSTRUCTIONS JACOB LOOSE FLANGE CONNECTION

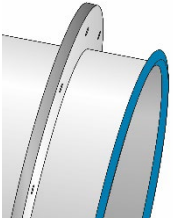

### Step 1

The loose flange is pushed back to one side of the flange connection in order to fit the U-shaped seal. Only one U-shaped seal is needed.

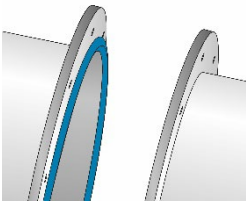

### Step 2

In the next step, the flange is pushed back into position against the U-shaped seal.

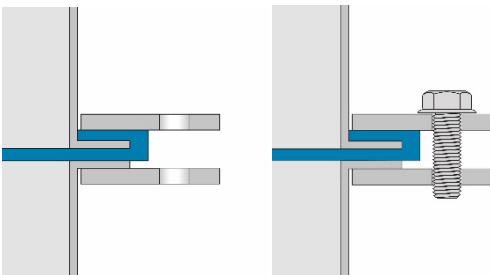

### Step 3

The two pipe ends are then brought together, taking care to align the holes of the two loose flanges.

The first hexagonal bolt, with washer, is inserted through the holes of both flanges. A spring washer followed by the hexagon nut are then fitted on the protruding end of the bolt.

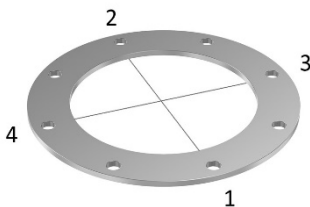

### Step 4

The next bolts should be fitted in the sequence 2, 3, 4.

The remaining bolts can then be fitted in any order.

Once the bolts have been fitted, M10 bolts must be tightened with a torque of **40 Nm** (M12 bolts with 60 Nm and M16 bolts with 80 Nm). The bolts should be tightened in the same order followed for installation: 1, 2, 3 etc. To disassemble the connection, follow the instructions in reverse order.

## Installation with welded-on flanges

In the case of welded-on flanges, a flat gasket is fitted instead of a U-shaped seal. The further installation follows the same sequence of steps described above.